



Republic of the Philippines
Department of Education
Cordillera Administrative Region

REQUEST FOR QUOTATION
(RFQ No. 20-09-065)

PROJECT: SUPPLY, DELIVERY AND INSTALLATION OF OFFICE FURNITURES

INVITATION

Date: September 15, 2020

Request for Quotation No.: 20-09-065

To Eligible Suppliers:

The DepED-CAR Regional Office through its Bids and Awards Committee (BAC), invites suppliers to quote for the project **SUPPLY, DELIVERY AND INSTALLATION OF OFFICE FURNITURES**

Quotations should be **inclusive** of tax. The total approved Budget for the project is **Php 120,000.00**

Quotations with supporting documents may be submitted in person, by letter, facsimile or thru email at depedcar.bacsecretariat@gmail.com **not later than 2 pm of September 21, 2020**. For any inquiry, please refer to the members of the BAC Secretariat at DepED-CAR RO, Wangal, La Trinidad, Benguet with telefax numbers (074) 422-1804 / 422-5155. Upon receipt of quotation/s on the submission deadline, the BAC shall open the quotations.

Very truly yours,

FLORANTE E. VERGARA
BAC Chairperson

Bacsec/CDAD/jlc



Address: Wangal, La Trinidad, Benguet, 2601
Telephone No: (074) 422 – 1318 | **Fax No.:** (074) 422-4074
Website: www.depedcar.ph | **Email Address:** car@deped.gov.ph



ISO 9001:2015 Certified
Quality Management System
DE-50500784 QM15



Republic of the Philippines
Department of Education
Cordillera Administrative Region

I. QUOTATION FORM
(RFQ No. 20-09-065)

SUPPLY, DELIVERY AND INSTALLATION OF OFFICE FURNITURES

ABC: Php 120,00.00

Item No.	Description	Unit	Quantity	Unit Price	Total
1	0.46 x 1.65 x 2.00m All Wood Filing cabinet with open shelves and sliding glass door; (see attached details and specifications)	units	4		
2	0.46 x 0.99 x 2.00m All Wood Filing cabinet with open shelves and sliding glass door; (see attached details and specifications)	units	4		
3	All wood office table with pull out drawers; (see attached details and specifications)	unit	1		
TOTAL					

Respectfully returned to the Chairman of the BAC, DepED-CAR RO, with prices (inclusive of tax) herein quoted. All requirements/terms/conditions specified by that Office in this RFQ (Section I and Section II) are hereby accepted.

Name of Business and Signature of Supplier
Contact No. _____



Address: Wangal, La Trinidad, Benguet, 2601
Telephone No: (074) 422 – 1318 | Fax No.: (074) 422-4074
Website: www.depedcar.ph | Email Address: car@deped.gov.ph



ISO 9001:2015 Certified
Quality Management System
DE-50500784 QM15



Republic of the Philippines
Department of Education
Cordillera Administrative Region

II. TERMS AND CONDITIONS
(RFQ No. 20-09-065)

A. Submission of Quotations

The Requests for Quotation documents can be faxed or emailed to you upon request provided you provide your telefax number/email address. These may also be taken at the Administrative Division Office of the DepED-CAR Regional Office.

Quotations and any other requirement stated below, if submitted personally, should be received at the Administrative Division Office at DepED- CAR Regional Office, Wangal, La Trinidad, Benguet. **On or before 2 pm of September 21, 2020** Quotations submitted by the supplier should be ***inclusive of tax.***

B. Requirements

The supplier should:

1. Submit duly accomplished/signed ***Request for Quotation (RFQ) Documents (Section I and Section II)*** together with the copies of the following:

- i. 2020 Mayor's Permit/Business Permit
- ii. PhilGEPS Registration number

On or before 2 pm of September 21, 2020;

2. Submit
 - i. Income/Business Tax Return
 - ii. Omnibus Sworn Statement***prior to Notice of award.***





Republic of the Philippines
Department of Education
Cordillera Administrative Region

C. Award/Contract

1. DepED-CAR RO shall award the Purchase Order to the supplier whose offer is determined to be the lowest complying and responsive quotation.
2. The quotation of the supplier and his acceptance of the Purchase Order shall constitute a binding contract between DepED-CAR RO and the Supplier.
3. Contract duration shall be 15 calendar days from the date of receipt of the Purchase Order.

D. Deliveries and Inspection

1. RA 7394 or the Consumer's Welfare Act shall be applied in cases of defective supplies, for supplies delivered which are not in accordance with the specifications and for other applicable situations.

- E.** DepED-CAR RO reserves the right to accept or reject any quotation, to annul or cancel the process, and to reject all quotations at any time prior to the award of the Purchase Order, without thereby incurring any liability to the affected Supplier(s). It has no responsibility whatsoever to compensate the supplier for any expense incurred in the preparation of the quotation nor does it have any obligation to inform the affected Supplier(s) of the reasons of its decision.

I hereby concur/certify to comply with the above terms/conditions:

Name of supplier

Signature Over Printed Name of
Representative

Date



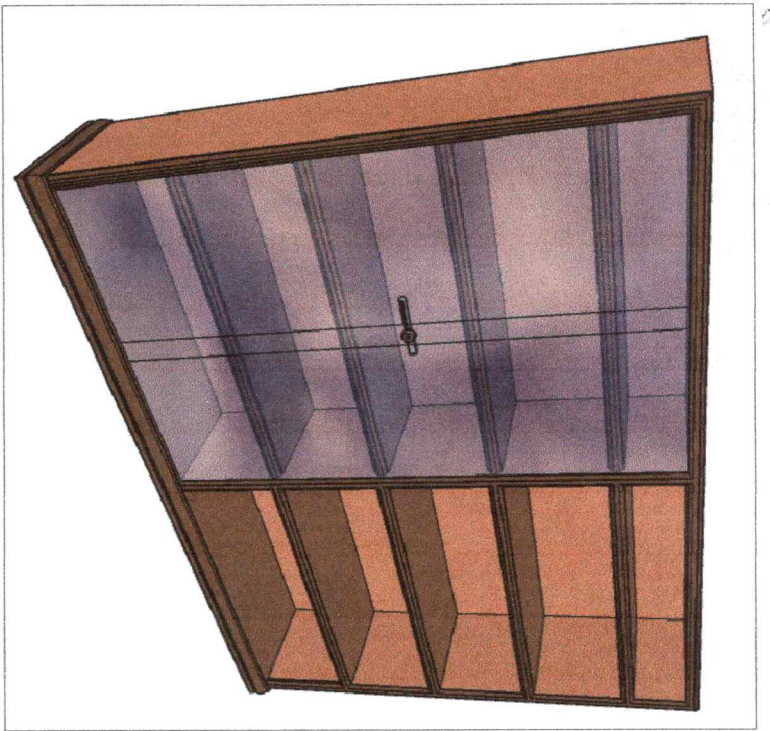

PERSPECTIVE

SPECIFICATIONS

- UNIT: 4 UNITS
- MATERIALS:
 - SOLID WOOD
 - STILES: ROUTED EDGES ON EXPOSED PORTIONS
 - RAILS: SOLID WOOD
 - TOE KICK: SOLID WOOD
 - BASE BOARD
 - PANELS: MARINE PLYWOOD
 - 1/2" THICK
 - SHELVES: MARINE PLYWOOD
 - 3/4" THICK
 - FINISH: 3 COAT VARNISH
 - OTHERS: SHOP STANDARD

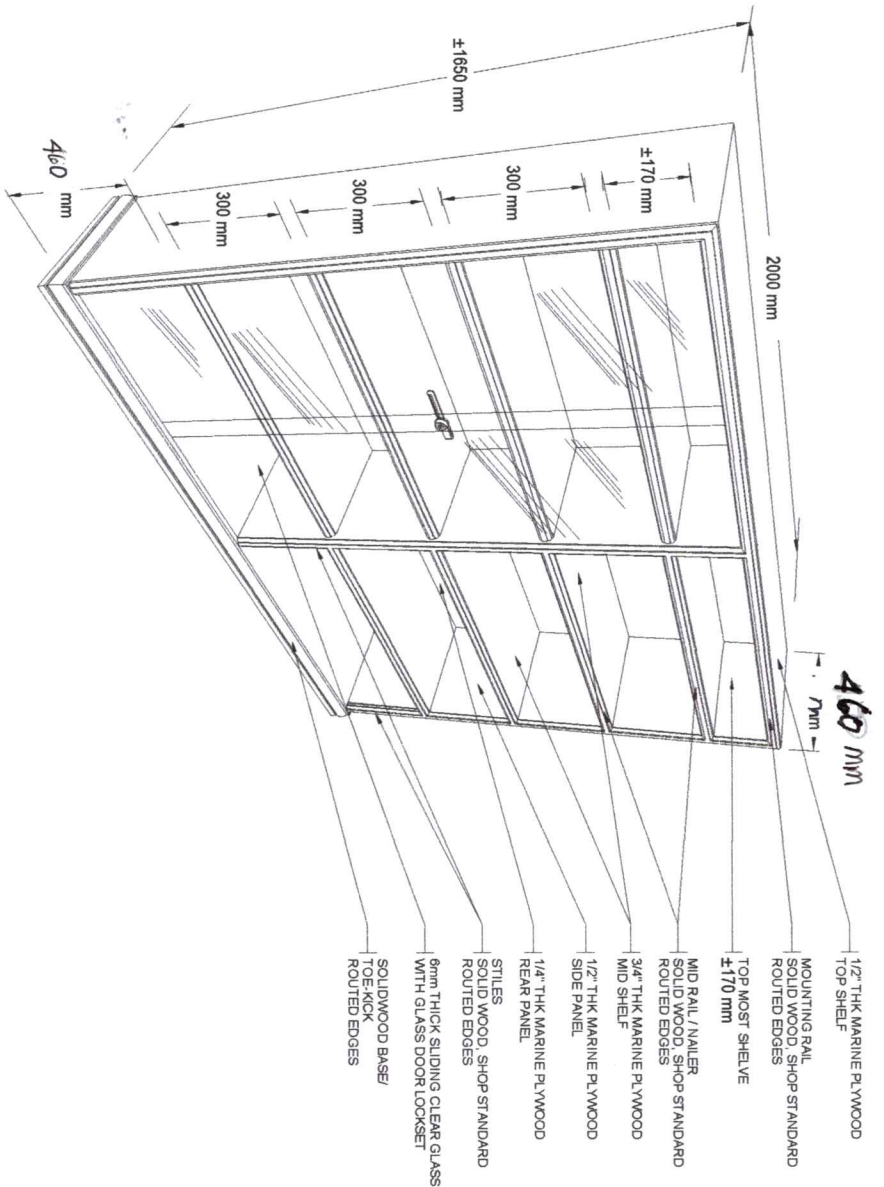

FILING CABINET

PREPARED BY:

CULLEN S. WEGIYON

DRAWN BY:

August 2020

LOCATION: WANGAL, LA TRINIDAD, BENGUET

OWNER:

DEPARTMENT OF EDUCATION - CAR
 REGIONAL OFFICE

SHEET CONTENT:

AS SHOWN

SHEET NO.:

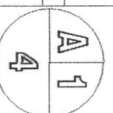

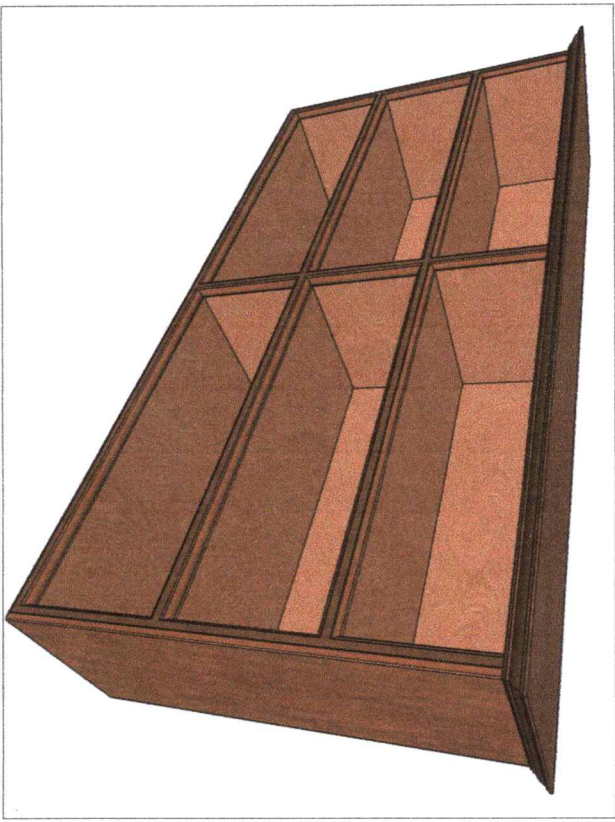

SPECIFICATIONS

UNIT: 4 UNITS

MATERIALS:

- STILES:** SOLID WOOD
ROUTED EDGES ON EXPOSED PORTIONS
- RAILS:** SOLID WOOD
ROUTED EDGES ON EXPOSED PORTIONS
- TOP RAIL:** SOLID WOOD
CORNICHE ATTACHED
- SIDE & PARTITION PANELS:** MARINE PLYWOOD
1 1/2" THICK
- TOP & REAR PANELS:** MARINE PLYWOOD
1/4" THICK
- SHELVES:** MARINE PLYWOOD
3/4" THICK
- FINISH:** 3 COAT VARNISH
- OTHERS:** SHOP STANDARD
PROVIDE MOUNTING RAILS

PERSPECTIVE

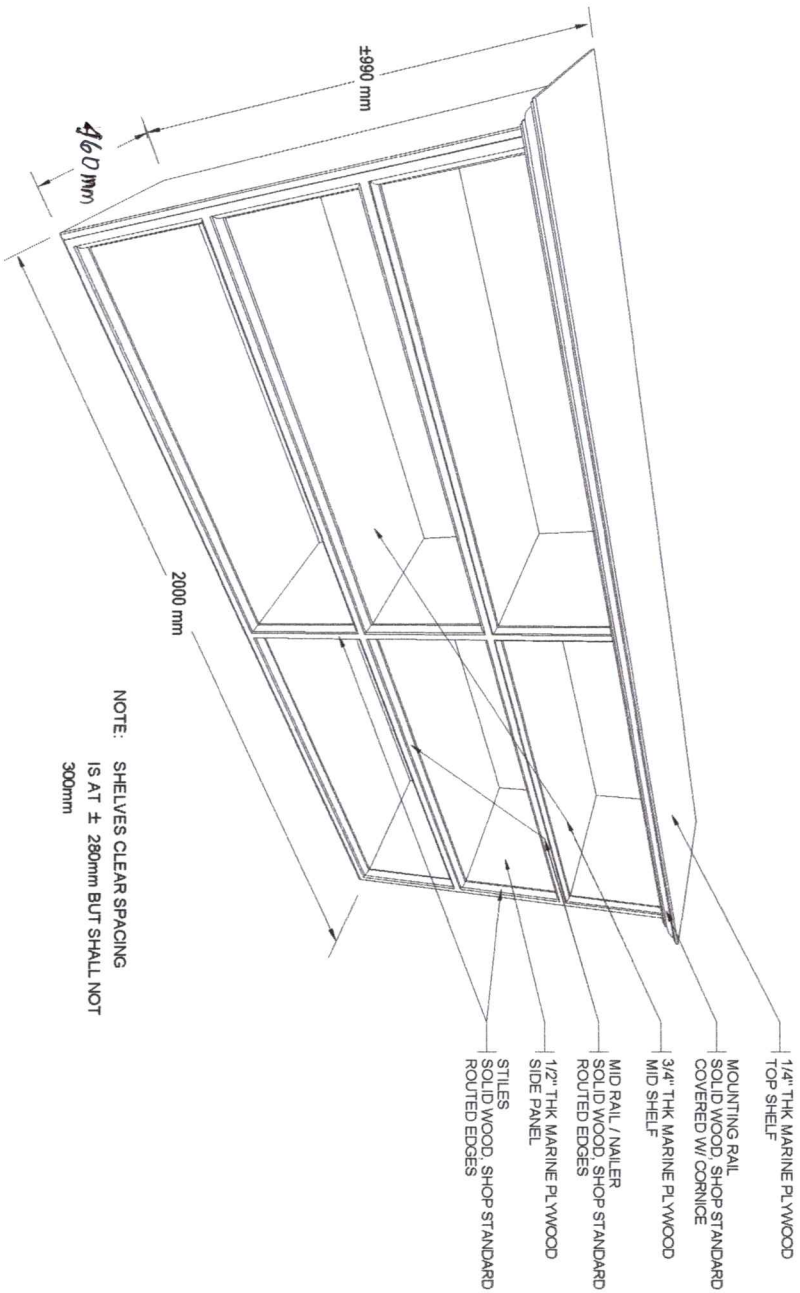
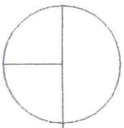

NOTE: SHELVES CLEAR SPACING IS AT ± 280mm BUT SHALL NOT 300mm

WALL HUNG CABINET

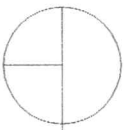

PREPARED BY:

CULLEN S. WEGIYON

DRAFTER/DATE

August 2020

LOCATION: WANGAL, LA TRINIDAD, BENGUET

OWNER:

DEPARTMENT OF EDUCATION - CAR
 REGIONAL OFFICE

SHEET CONTENT:

AS SHOWN

SHEET NO.:

A
2
4

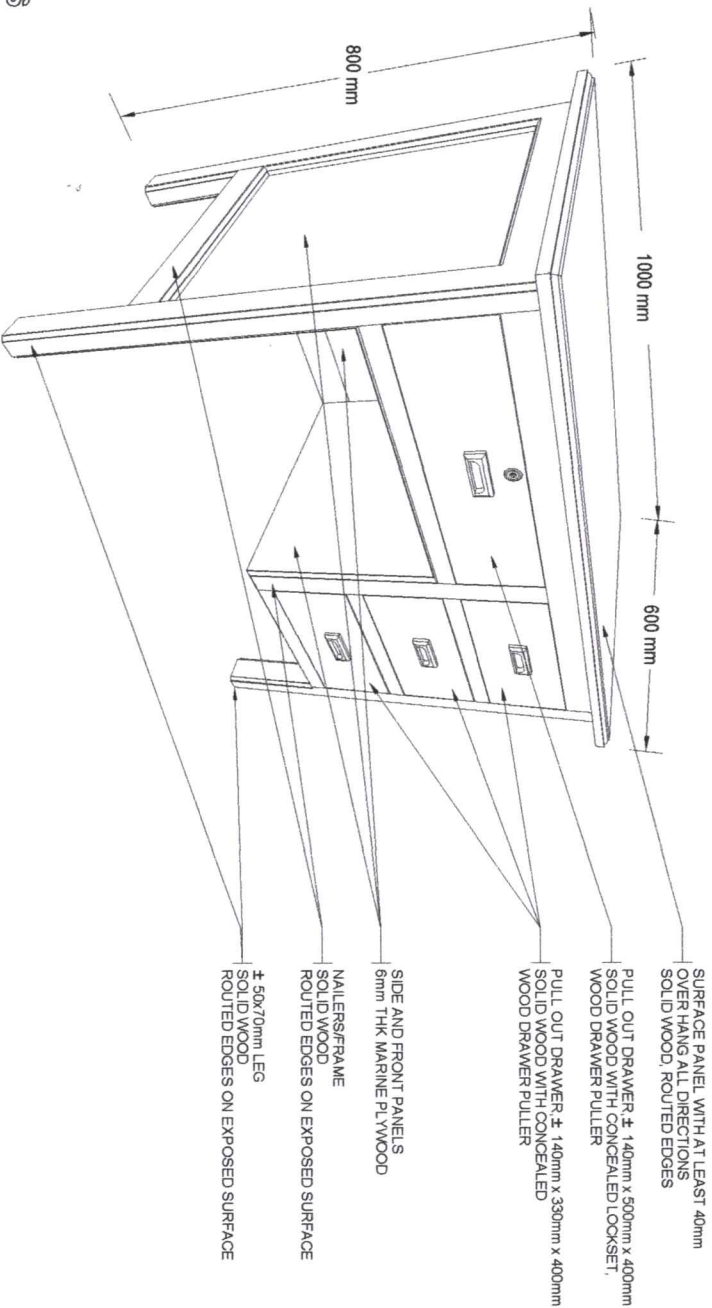
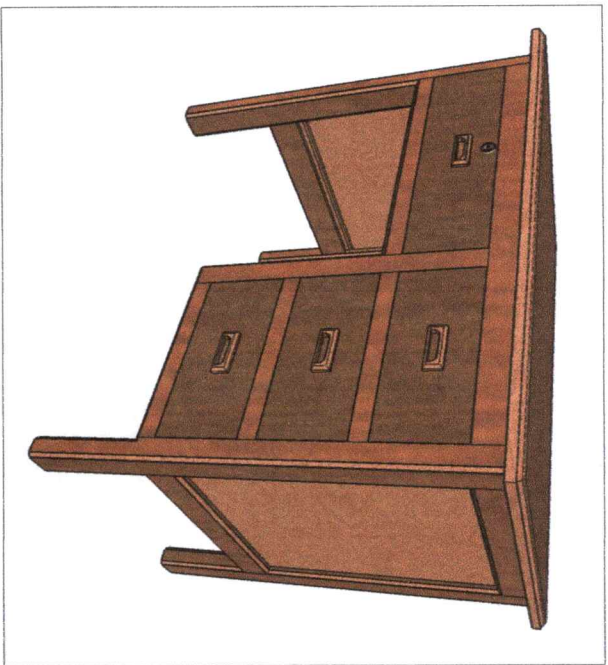

SPECIFICATIONS

UNIT: 1 UNIT

MATERIALS:

- APRON/SKIRT: SOLID WOOD
- ROUTED EDGES ON EXPOSED PORTIONS
- LEG: SOLID WOOD
- ROUTED EDGES ON EXPOSED PORTIONS
- FRAMES/STRETCHER: SOLID WOOD
- ROUTED EDGES ON EXPOSED PORTIONS
- SIDE & FRONT PANELS: MARINE PLYWOOD
1/4" THICK
- SURFACE PANELS: SOLID WOOD
- ROUTED EDGES
- PULL OUT DRAWER: SOLID WOOD
- CONCEALED LOCKSET AND PULLER
- FINISH: 3 COAT VARNISH
- OTHERS: SHOP STANDARD

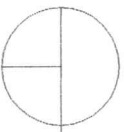

PERSPECTIVE

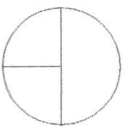

OFFICE TABLE

PREPARED BY:

CULLEN S. WEGYON

DRAFTSMAN II

August 2008

LOCATION:

WANGAL, LA TRINIDAD, BENGUET

OWNER:

DEPARTMENT OF EDUCATION - CAR
 REGIONAL OFFICE

SHEET CONTENT:

AS SHOWN

SHEET NO.:

A 3
 4

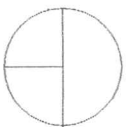
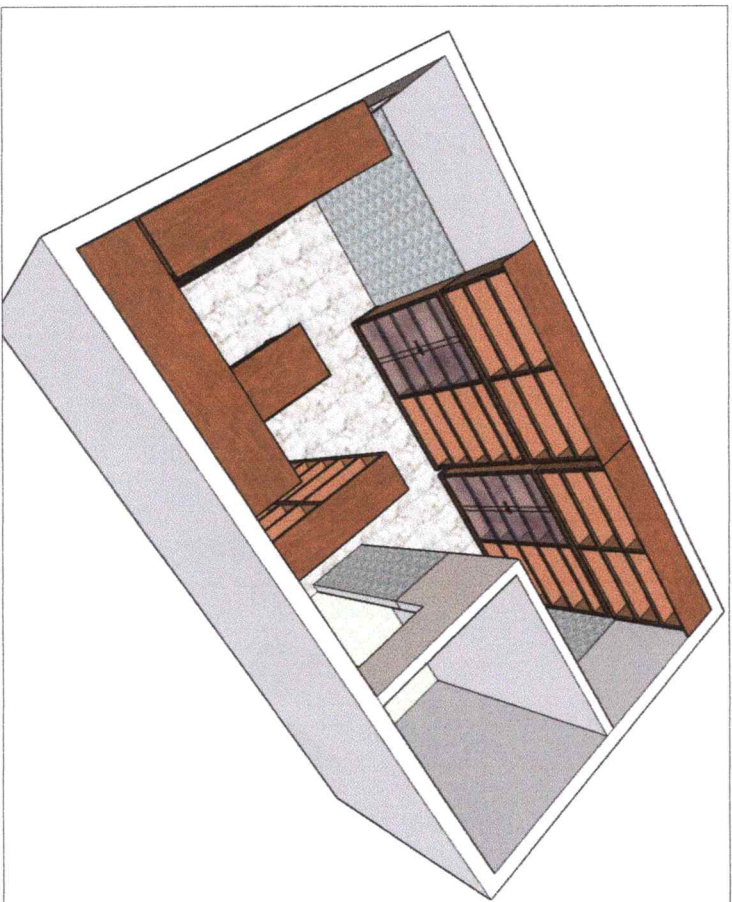
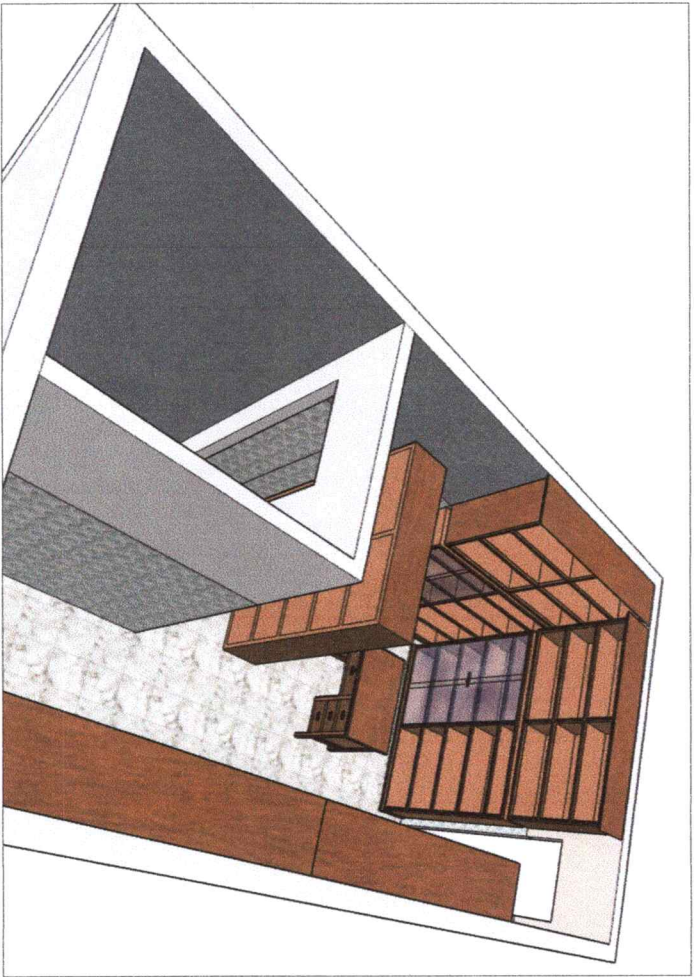

MOUNTING SETUP

PREPARED BY:

CULLEN S. WEGYON

DR. ARCHITECT

August 2020

LOCATION:

WANGAL, LA TRINIDAD, BENGUET

OWNER:

DEPARTMENT OF EDUCATION - CAR
 REGIONAL OFFICE

SHEET CONTENT:

AS SHOWN

SHEET NO.:

A
4
4